

AUBO-i3

i Series Collaborative Robot

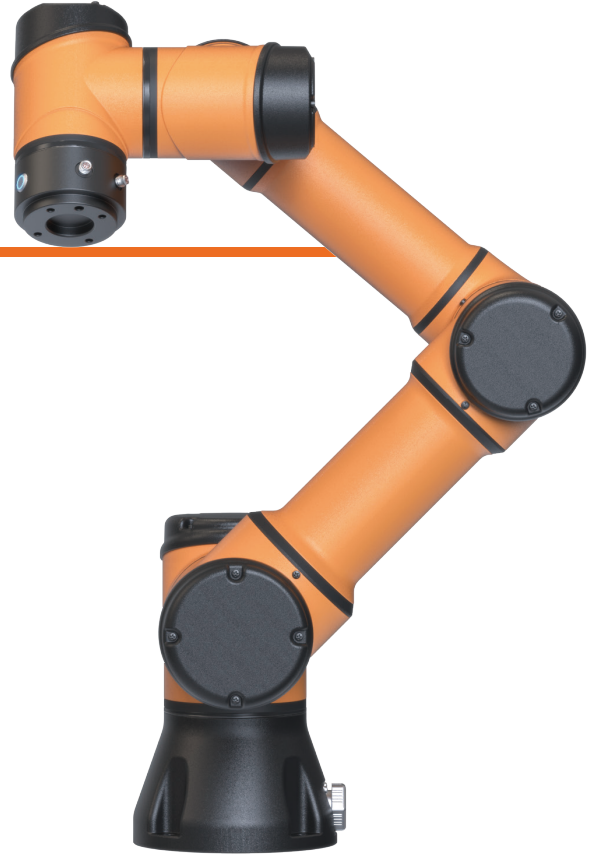

3KG
PAYLOAD



16.4KG
WEIGHT



±0.02mm
REPEATABILITY



625mm
WORKING RADIUS

- ✓ Ultra-lightweight: 16.4kg self-weight
- ✓ Performance: 3kg payload | 625mm max reach
- ✓ Advantage: Compact, portable, and minimal footprint

Applications

3C, Automotive, New Energy, Semiconductors, Machining, Hardware & Appliances, Kitchen/Bath, Healthcare, Research & Education, F&B (Food & Beverage), New Retail, Daily Chemicals, Logistics.



CERTIFICATIONS

- ISO 13849(PL d with Cat. 3)
- CE Certification
- NRTL Certification
- KCs Certification
- CR Certification
- SEMI S2 Certification
- RoHS Certification
- ISO class 4 Cleanroom ISO Class 4



Features & Advantages

(Compared to the previous generation of products)

- 01 Higher Precision:**
Optimized repeatability and power-on accuracy. Millisecond response ensures smooth and precise trajectories.
- 02 Increased Speed:**
Operating speed boosted by 10%-20% for highly efficient 6-DOF performance and maximum productivity.
- 03 Stronger Functionality:**
Open platform with flange RS485, high-current support, and new end-effector drag-to-teach. Seamless integration with diverse grippers, vision, and mobile peripherals.
- 04 Superior Safety:**
Fully certified and highly stable. Upgraded collision detection enables fenceless, ultra-safe human-machine collaboration.



High Performance



High Precision



Rapid Response



Safe and Stable



Flexible Production



Fine Craftsmanship



Compact and Lightweight



Modular Design



High Protection Class



...

AUBO-i5

i Series Collaborative Robot



5KG
PAYLOAD



23.3KG
WEIGHT



±0.02mm
REPEATABILITY



886.5mm
WORKING RADIUS

- ✓ The AUBO-i5 cobot meets lightweight operational requirements.
- ✓ Payload: 5kg | Max Working Radius: 886.5mm.
- ✓ Widely applicable with rich configurations.

Applications

3C, Automotive, New Energy, Semiconductors, Machining, Hardware & Appliances, Kitchen/Bath, Healthcare, Research & Education, F&B (Food & Beverage), New Retail, Daily Chemicals, Logistics.



CERTIFICATIONS

- ISO 13849(PL d with Cat. 3)
- CE Certification
- NRTL Certification
- KCs Certification
- CR Certification
- SEMI S2 Certification
- RoHS Certification
- ISO class 4 Cleanroom ISO Class 4



Features & Advantages

(Compared to the previous generation of products)

- 01 Higher Precision:**
Optimized repeatability and power-on accuracy. Millisecond response ensures smooth and precise trajectories.
- 02 Increased Speed:**
Operating speed boosted by 10%-20% for highly efficient 6-DOF performance and maximum productivity.
- 03 Stronger Functionality:**
Open platform with flange RS485, high-current support, and new end-effector drag-to-teach. Seamless integration with diverse grippers, vision, and mobile peripherals.
- 04 Superior Safety:**
Fully certified and highly stable. Upgraded collision detection enables fenceless, ultra-safe human-machine collaboration.



High Performance



High Precision



Rapid Response



Safe and Stable



Flexible Production



Fine Craftsmanship



Compact and Lightweight



Modular Design



High Protection Class



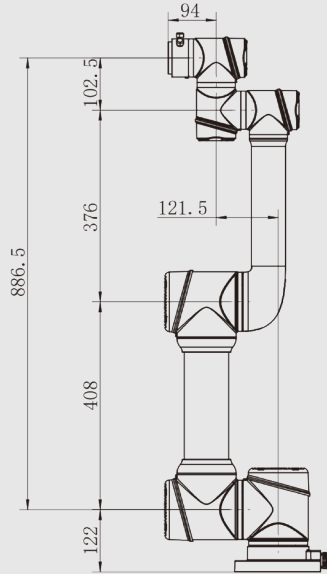

AUBO-i5 Dimensions Diagram

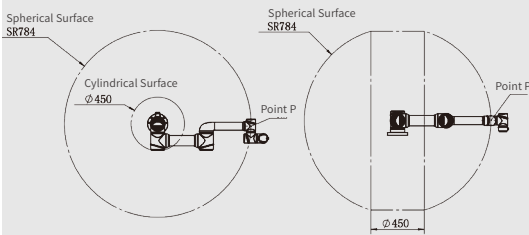

AUBO-i5 Point P Motion Range

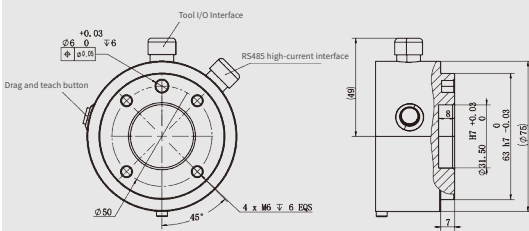

AUBO-i5 End Flange

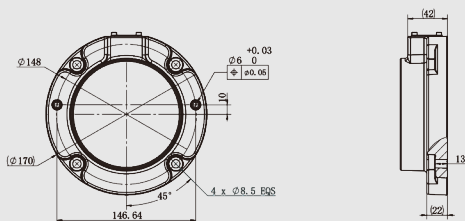

AUBO-i5 Base Top View

Robot

Degrees of Freedom	6
Max Working Radius (mm)	886.5
Payload (kg)	5
Weight (kg)	23.3
Footprint Diameter (mm)	$\phi 170$
Repeatability (mm)	± 0.02
Tool Speed (m/s)	≤ 3.4
Average Power (W)	200
Peak Power (W)	2000
Operating Temp. Range (°C)	0-50
Operating Humidity	90% RH (Non-condensing)
Mounting	Any angle
IP Classification	IP54

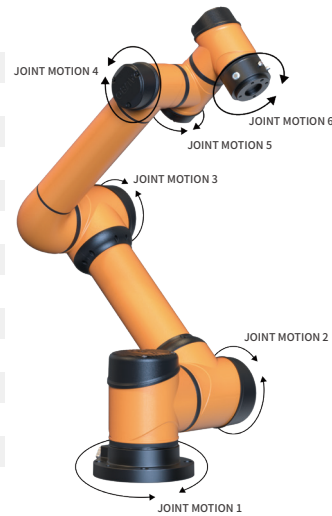

Joint Motion

Joint Motion	Range of Motion(°)	Max Speed (°/s)
joint 1	± 360	223
joint 2	± 360	223
joint 3	± 162	223
joint 4	± 360	237
joint 5	± 360	237
joint 6	± 360	237

* Joint motion capabilities may be limited by application scenarios; maximum speeds may not be reached. Please note this during use.

Control Cabinet

Product Model	AUBO-CB-IS
Dimensions (L*H*W)	400mm*320mm*160mm
Weight	12.5kg
Robot Arm Cable Length	5m (Customizable, up to 8m)
Teach Pendant Cable Length	4m
Power Cable Length	5m
Communication Protocols	Ethernet, ModBus-RTU/TCP, Profinet, Ethernet/IP (Optional)
Interfaces & Openness	SDK (C/C++/C#/Lua/Python/JavaScript Windows + Linux), supporting ROS/ROS2, AP
Power Supply	115/230VAC, 50/60Hz
IP Classification	IP43



I/O Interfaces

	Control Cabinet	Tool End	
I/O Interfaces	Digital Input	16(Standard),16(Configurable)/8(Safety)	4 (Configurable)
	Digital Output	16(Standard),16(Configurable)/8(Safety)	4 (Configurable)
	Analog Input	2	2
	Analog Output	2	-
	RS485 Communication	2	1 (Configurable)
I/O Power	Output Voltage	24V	0V/12V/24V
	Output Current	3A Max	2A (3A Max)

Teach Pendant

Product Model	AUBO-TP-IS
Dimensions (L*H*W)	254mm*213.1mm*40.8mm
Weight	1.0kg
IP Classification	IP54
Color	Orange + Black



Disclaimer

- The content of this product datasheet is subject to change without prior notice.
- This product datasheet is the intellectual property of our company, and all rights are reserved. Any reproduction or citation of the content must indicate the source. Unauthorized reproduction is strictly prohibited; violators will be considered infringing and will be held legally liable in accordance with the law.



AUBO-i7

i Series Collaborative Robot



7KG
PAYLOAD



23.2KG
WEIGHT



±0.02mm
REPEATABILITY



786.5mm
WORKING RADIUS

- ✓ The AUBO-i7 cobot meets lightweight operational requirements.
- ✓ Payload: 7kg | Max Working Radius: 786.5mm.
- ✓ Widely applicable with rich configurations.

Applications

3C, Automotive, New Energy, Semiconductors, Machining, Hardware & Appliances, Kitchen/Bath, Healthcare, Research & Education, F&B (Food & Beverage), New Retail, Daily Chemicals, Logistics.



CERTIFICATIONS

- ISO 13849(PL d with Cat. 3)
- CE Certification
- NRTL Certification
- KCs Certification
- CR Certification
- SEMI S2 Certification
- RoHS Certification
- ISO class 4 Cleanroom ISO Class 4



Features & Advantages

(Compared to the previous generation of products)

- 01 Higher Precision:**
Optimized repeatability and power-on accuracy. Millisecond response ensures smooth and precise trajectories.
- 02 Increased Speed:**
Operating speed boosted by 10%-20% for highly efficient 6-DOF performance and maximum productivity.
- 03 Stronger Functionality:**
Open platform with flange RS485, high-current support, and new end-effector drag-to-teach. Seamless integration with diverse grippers, vision, and mobile peripherals.
- 04 Superior Safety:**
Fully certified and highly stable. Upgraded collision detection enables fenceless, ultra-safe human-machine collaboration.



High Performance



High Precision



Rapid Response



Safe and Stable



Flexible Production



Fine Craftsmanship



Compact and Lightweight



Modular Design



High Protection Class



...

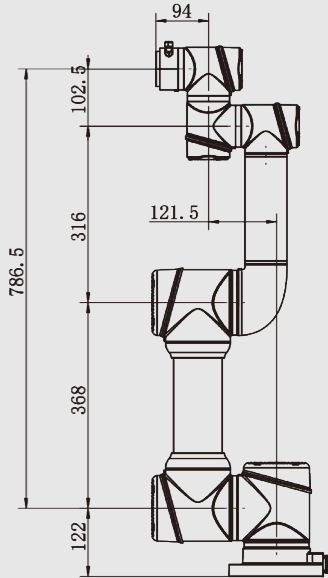

AUBO-i7 Dimensions Diagram

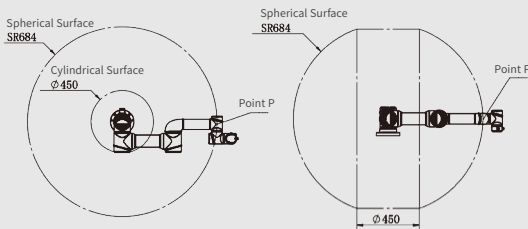

AUBO-i7 Point P Motion Range

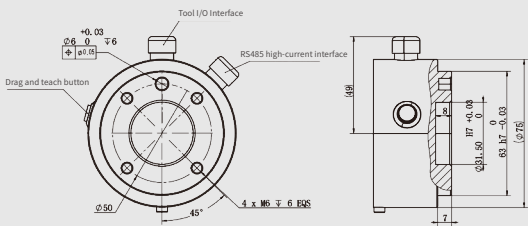

AUBO-i7 End Flange

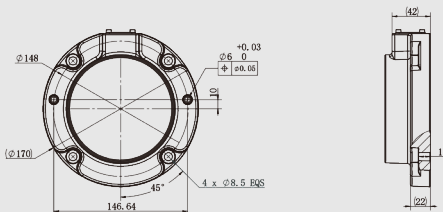

AUBO-i7 Base Top View

Robot

Degrees of Freedom	6
Max Working Radius (mm)	786.5
Payload (kg)	7
Weight (kg)	23.2
Footprint Diameter (mm)	$\phi 170$
Repeatability (mm)	± 0.02
Tool Speed (m/s)	≤ 3.0
Average Power (W)	200
Peak Power (W)	2000
Operating Temp. Range ($^\circ\text{C}$)	0-50
Operating Humidity	90% RH (Non-condensing)
Mounting	Any angle
IP Classification	IP54

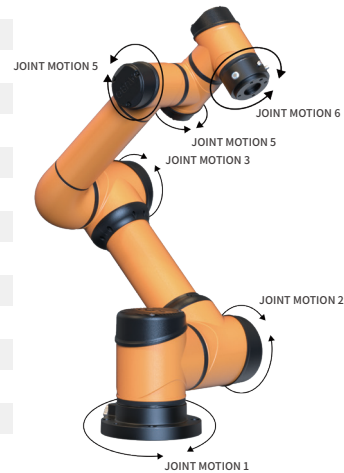

Joint Motion

Joint Motion	Range of Motion ($^\circ$)	Max Speed ($^\circ/\text{s}$)
joint 1	± 360	223
joint 2	± 360	223
joint 3	± 158	223
joint 4	± 360	237
joint 5	± 360	237
joint 6	± 360	237

* Joint motion capabilities may be limited by application scenarios; maximum speeds may not be reached. Please note this during use.

Control Cabinet

Product Model	AUBO-CB-IS
Dimensions (L*H*W)	400mm*320mm*160mm
Weight	12.5kg
Robot Arm Cable Length	5m (Customizable, up to 8m)
Teach Pendant Cable Length	4m
Power Cable Length	5m
Communication Protocols	Ethernet, ModBus-RTU/TCP, Profinet, Ethernet/IP (Optional)
Interfaces & Openness	SDK (C/C++/C#/Lua/Python/JavaScript Windows + Linux), supporting ROS/ROS2, AP
Power Supply	115/230VAC, 50/60Hz
IP Classification	IP43



I/O Interfaces

	Control Cabinet	Tool End	
I/O Interfaces	Digital Input	16(Standard),16(Configurable)/8(Safety)	4 (Configurable)
	Digital Output	16(Standard),16(Configurable)/8(Safety)	4 (Configurable)
	Analog Input	2	2
	Analog Output	2	-
	RS485 Communication	2	1 (Configurable)
I/O Power	Output Voltage	24V	0V/12V/24V
	Output Current	3A Max	2A (3A Max)

Teach Pendant

Product Model	AUBO-TP-IS
Dimensions (L*H*W)	254mm*213.1mm*40.8mm
Weight	1.0kg
IP Classification	IP54
Color	Orange + Black



Disclaimer

- The content of this product datasheet is subject to change without prior notice.
- This product datasheet is the intellectual property of our company, and all rights are reserved. Any reproduction or citation of the content must indicate the source. Unauthorized reproduction is strictly prohibited; violators will be considered infringing and will be held legally liable in accordance with the law.



AUBO-i10

i Series Collaborative Robot

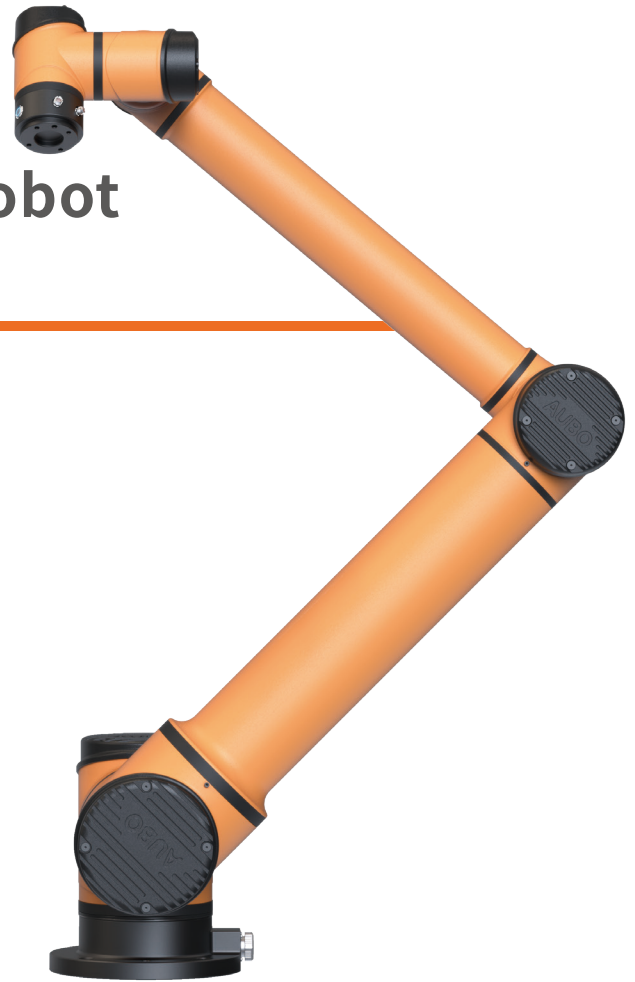

10KG

PAYLOAD



39.2KG

WEIGHT



±0.03mm

REPEATABILITY



1350mm

WORKING RADIUS

- ✓ The AUBO-i10 cobot features a maximum working radius of 1350mm.
- ✓ Payload of 10kg, combined with a repeatability of ±0.03mm.
- ✓ Heavy payload and extensive reach.

Applications

3C, Automotive, New Energy, Semiconductors, Machining, Hardware & Appliances, Kitchen/Bath, Healthcare, Research & Education, F&B (Food & Beverage), New Retail, Daily Chemicals, Logistics.



CERTIFICATIONS

- ISO 13849(PL d with Cat. 3)
- CE Certification
- NRTL Certification
- KCs Certification
- CR Certification
- SEMI S2 Certification
- RoHS Certification
- ISO class 4 Cleanroom ISO Class 4



Features & Advantages

(Compared to the previous generation of products)

- 01 Higher Precision:**
Optimized repeatability and power-on accuracy. Millisecond response ensures smooth and precise trajectories.
- 02 Increased Speed:**
Operating speed boosted by 10%-20% for highly efficient 6-DOF performance and maximum productivity.
- 03 Stronger Functionality:**
Open platform with flange RS485, high-current support, and new end-effector drag-to-teach. Seamless integration with diverse grippers, vision, and mobile peripherals.
- 04 Superior Safety:**
Fully certified and highly stable. Upgraded collision detection enables fenceless, ultra-safe human-machine collaboration.



High Performance



High Precision



Rapid Response



Safe and Stable



Flexible Production



Fine Craftsmanship



Compact and Lightweight



Modular Design



High Protection Class

...

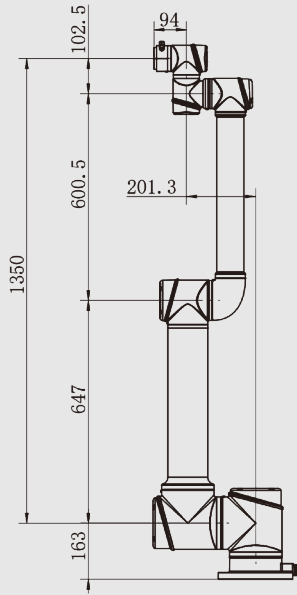

AUBO-i10 Dimensions Diagram

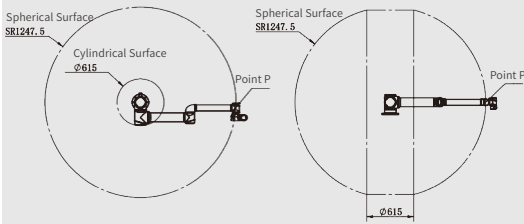

AUBO-i10 Point P Motion Range

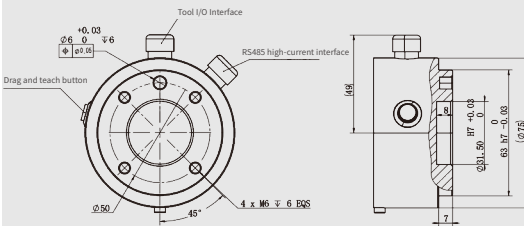

AUBO-i10 End Flange

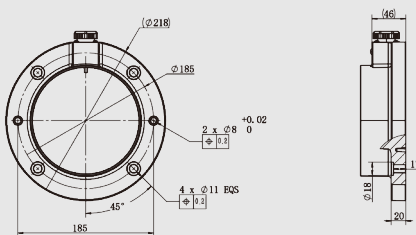

AUBO-i10 Base Top View

Robot

Degrees of Freedom	6
Max Working Radius (mm)	1350
Payload (kg)	10
Weight (kg)	39.2
Footprint Diameter (mm)	Ø218
Repeatability (mm)	±0.03
Tool Speed (m/s)	≤4.0
Average Power (W)	500
Peak Power (W)	2000
Operating Temp. Range (°C)	0-50
Operating Humidity	90% RH (Non-condensing)
Mounting	Any angle
IP Classification	IP54

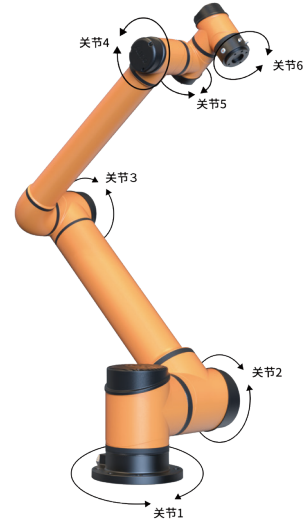

Joint Motion

Joint	Range of Motion(°)	Max Speed (°/s)
joint 1	±360	178
joint 2	±360	178
joint 3	±167	223
joint 4	±360	237
joint 5	±360	237
joint 6	±360	237

* Joint motion capabilities may be limited by application scenarios; maximum speeds may not be reached. Please note this during use.

Control Cabinet

Product Model	AUBO-CB-IS
Dimensions (L*H*W)	400mm*320mm*160mm
Weight	12.5kg
Robot Arm Cable Length	5m (Customizable, up to 8m)
Teach Pendant Cable Length	4m
Power Cable Length	5m
Communication Protocols	Ethernet, ModBus-RTU/TCP, Profinet, Ethernet/IP (Optional)
Interfaces & Openness	SDK (C/C++/C#/Lua/Python/JavaScript Windows + Linux), supporting ROS/ROS2, AP
Power Supply	115/230VAC, 50/60Hz
IP Classification	IP43



I/O Interfaces

	Control Cabinet	Tool End
I/O Interfaces		
Digital Input	16(Standard),16(Configurable)/8(Safety)	4 (Configurable)
Digital Output	16(Standard),16(Configurable)/8(Safety)	4 (Configurable)
Analog Input	2	2
Analog Output	2	-
RS485 Communication	2	1 (Configurable)
I/O Power		
Output Voltage	24V	0V/12V/24V
Output Current	3A Max	2A (3A Max)

Teach Pendant

Product Model	AUBO-TP-IS
Dimensions (L*H*W)	254mm*213.1mm*40.8mm
Weight	1.0kg
IP Classification	IP54
Color	Orange + Black



Disclaimer

- The content of this product datasheet is subject to change without prior notice.
- This product datasheet is the intellectual property of our company, and all rights are reserved. Any reproduction or citation of the content must indicate the source. Unauthorized reproduction is strictly prohibited; violators will be considered infringing and will be held legally liable in accordance with the law.



AUBO-i12

i Series Collaborative Robot

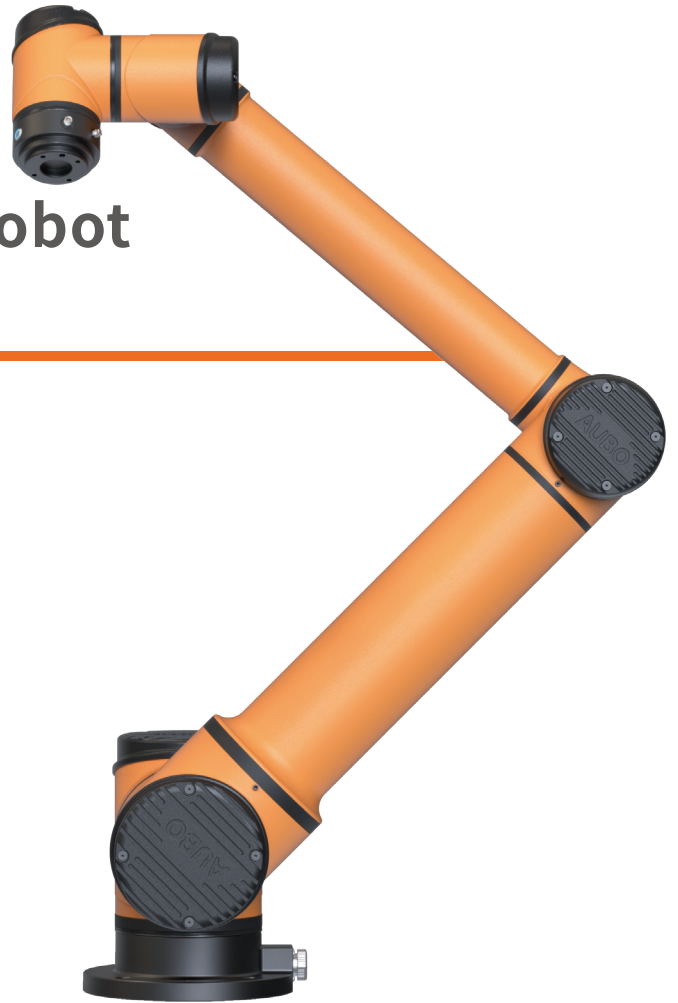

12KG

PAYLOAD



40.6KG

WEIGHT



±0.03mm

REPEATABILITY



1250mm

WORKING RADIUS

- ✓ The AUBO-i12 cobot features a maximum working radius of 1250mm.
- ✓ Payload of 12kg, combined with a repeatability of ±0.03mm.
- ✓ Heavy payload and extensive reach.

Applications

3C, Automotive, New Energy, Semiconductors, Machining, Hardware & Appliances, Kitchen/Bath, Healthcare, Research & Education, F&B (Food & Beverage), New Retail, Daily Chemicals, Logistics.



CERTIFICATIONS

- ISO 13849(PL d with Cat. 3)
- CE Certification
- NRTL Certification
- KCs Certification
- CR Certification
- SEMI S2 Certification
- RoHS Certification
- ISO class 4 Cleanroom ISO Class 4



Features & Advantages

(Compared to the previous generation of products)

- 01 Higher Precision:**
Optimized repeatability and power-on accuracy. Millisecond response ensures smooth and precise trajectories.
- 02 Increased Speed:**
Operating speed boosted by 10%-20% for highly efficient 6-DOF performance and maximum productivity.
- 03 Stronger Functionality:**
Open platform with flange RS485, high-current support, and new end-effector drag-to-teach. Seamless integration with diverse grippers, vision, and mobile peripherals.
- 04 Superior Safety:**
Fully certified and highly stable. Upgraded collision detection enables fenceless, ultra-safe human-machine collaboration.



High Performance



High Precision



Rapid Response



Safe and Stable



Flexible Production



Fine Craftsmanship



Compact and Lightweight



Modular Design



High Protection Class



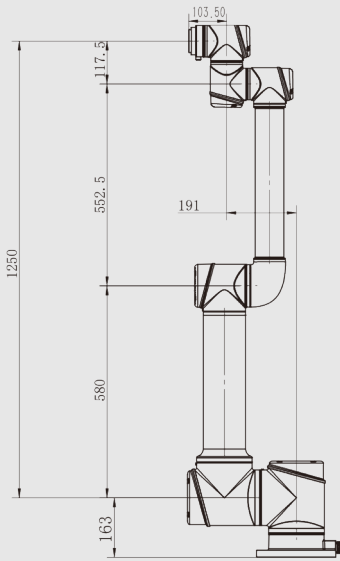

AUBO-i12 Dimensions Diagram

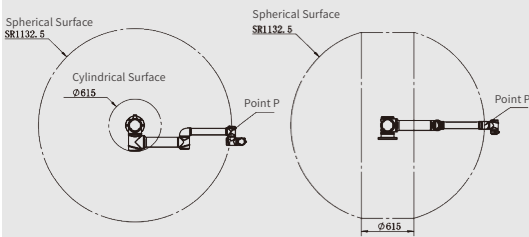

AUBO-i12 Point P Motion Range

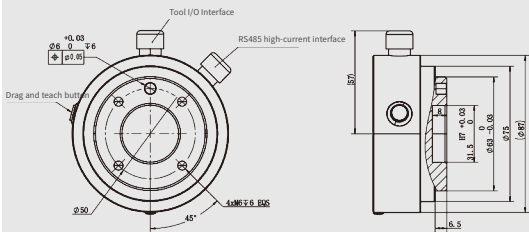

AUBO-i12 End Flange

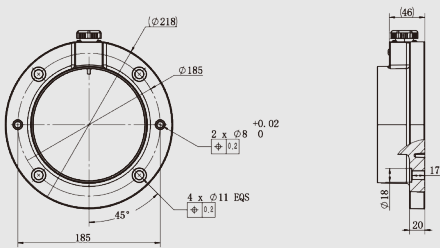

AUBO-i12 Base Top View

Robot

Degrees of Freedom	6
Max Working Radius (mm)	1250
Payload (kg)	12
Weight (kg)	40.6
Footprint Diameter (mm)	Ø218
Repeatability (mm)	±0.03
Tool Speed (m/s)	≤3.8
Average Power (W)	500
Peak Power (W)	2000
Operating Temp. Range (°C)	0-50
Operating Humidity	90% RH (Non-condensing)
Mounting	Any angle
IP Classification	IP54

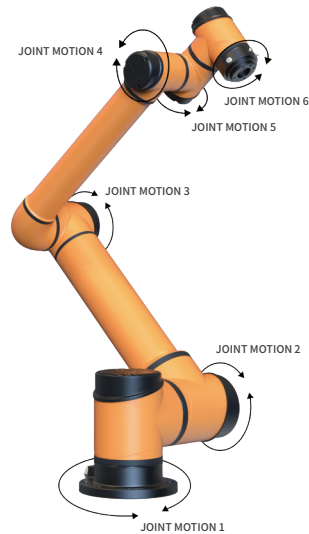

Joint Motion	Range of Motion(°)	Max Speed (°/s)
joint 1	±360	178
joint 2	±360	178
joint 3	±166	267
joint 4	±360	237
joint 5	±360	237
joint 6	±360	237

* Joint motion capabilities may be limited by application scenarios; maximum speeds may not be reached. Please note this during use.

Control Cabinet

Product Model	AUBO-CB-IS
Dimensions (L*H*W)	400mm*320mm*160mm
Weight	12.5kg
Robot Arm Cable Length	5m (Customizable, up to 8m)
Teach Pendant Cable Length	4m
Power Cable Length	5m
Communication Protocols	Ethernet, ModBus-RTU/TCP, Profinet, Ethernet/IP (Optional)
Interfaces & Openness	SDK (C/C++/C#/Lua/Python/JavaScript Windows + Linux) , supporting ROS/ROS2, AP
Power Supply	115/230VAC, 50/60Hz
IP Classification	IP43



I/O Interfaces

	Control Cabinet	Tool End
I/O Interfaces		
Digital Input	16(Standard),16(Configurable)/8(Safety)	4 (Configurable)
Digital Output	16(Standard),16(Configurable)/8(Safety)	4 (Configurable)
Analog Input	2	2
Analog Output	2	-
RS485 Communication	2	1 (Configurable)
I/O Power		
Output Voltage	24V	0V/12V/24V
Output Current	3A Max	2A (3A Max)

Teach Pendant

Product Model	AUBO-TP-IS
Dimensions (L*H*W)	254mm*213.1mm*40.8mm
Weight	1.0kg
IP Classification	IP54
Color	Orange + Black



Disclaimer

1. The content of this product datasheet is subject to change without prior notice.
2. This product datasheet is the intellectual property of our company, and all rights are reserved. Any reproduction or citation of the content must indicate the source. Unauthorized reproduction is strictly prohibited; violators will be considered infringing and will be held legally liable in accordance with the law.



AUBO-i16

i Series Collaborative Robot



16KG

PAYLOAD



38.9KG

WEIGHT



±0.03mm

REPEATABILITY



967.5mm

WORKING RADIUS

- ✓ The AUBO-i16 cobot features a maximum working radius of 967.5mm.
- ✓ Payload of 16kg, combined with a repeatability of ±0.03mm.
- ✓ Heavy payload and extensive reach.

Applications

3C, Automotive, New Energy, Semiconductors, Machining, Hardware & Appliances, Kitchen/Bath, Healthcare, Research & Education, F&B (Food & Beverage), New Retail, Daily Chemicals, Logistics.



CERTIFICATIONS

- ISO 13849(PL d with Cat. 3)
- CE Certification
- NRTL Certification
- KCs Certification
- CR Certification
- SEMI S2 Certification
- RoHS Certification
- ISO class 4 Cleanroom ISO Class 4



Features & Advantages

(Compared to the previous generation of products)

- 01 Higher Precision:**
Optimized repeatability and power-on accuracy. Millisecond response ensures smooth and precise trajectories.
- 02 Increased Speed:**
Operating speed boosted by 10%-20% for highly efficient 6-DOF performance and maximum productivity.
- 03 Stronger Functionality:**
Open platform with flange RS485, high-current support, and new end-effector drag-to-teach. Seamless integration with diverse grippers, vision, and mobile peripherals.
- 04 Superior Safety:**
Fully certified and highly stable. Upgraded collision detection enables fenceless, ultra-safe human-machine collaboration.



High Performance



High Precision



Rapid Response



Safe and Stable



Flexible Production



Fine Craftsmanship



Compact and Lightweight



Modular Design



High Protection Class



...

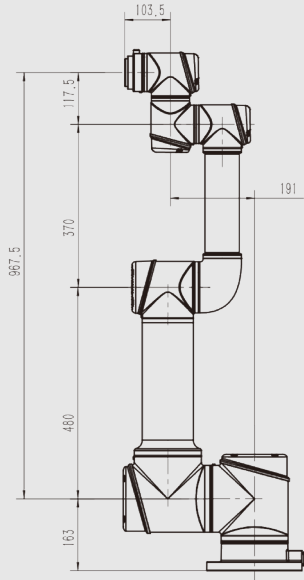

AUBO-i16 Dimensions Diagram

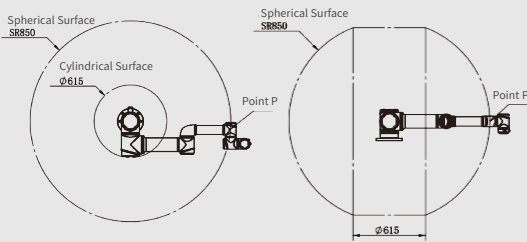

AUBO-i16 Point P Motion Range

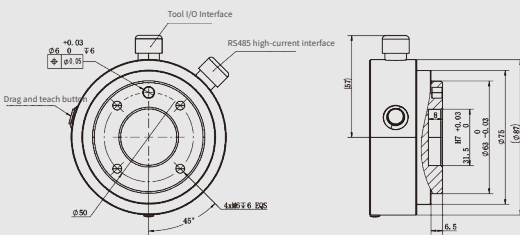

AUBO-i16 End Flange

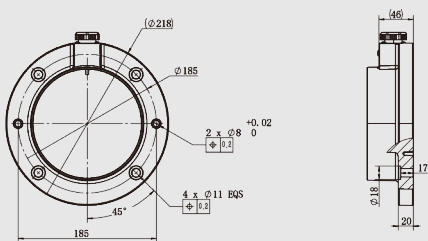

AUBO-i16 Base Top View

Robot

Degrees of Freedom	6
Max Working Radius (mm)	967.5
Payload (kg)	16
Weight (kg)	38.9
Footprint Diameter (mm)	Ø218
Repeatability (mm)	±0.03
Tool Speed (m/s)	≤3.0
Average Power (W)	600
Peak Power (W)	2000
Operating Temp. Range (°C)	0-50
Operating Humidity	90% RH (Non-condensing)
Mounting	Any angle
IP Classification	IP54

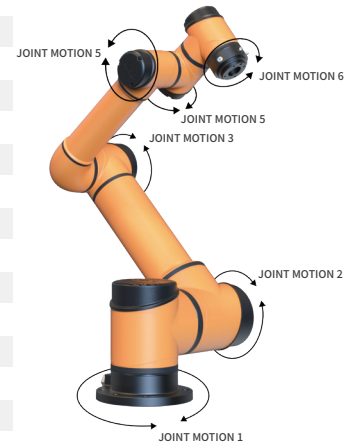

Joint Motion	Range of Motion(°)	Max Speed (°/s)
joint 1	±360	178
joint 2	±360	178
joint 3	±161	267
joint 4	±360	237
joint 5	±360	237
joint 6	±360	237

* Joint motion capabilities may be limited by application scenarios; maximum speeds may not be reached. Please note this during use.

Control Cabinet

Product Model	AUBO-CB-IS
Dimensions (L*H*W)	400mm*320mm*160mm
Weight	12.5kg
Robot Arm Cable Length	5m (Customizable, up to 8m)
Teach Pendant Cable Length	4m
Power Cable Length	5m
Communication Protocols	Ethernet, ModBus-RTU/TCP, Profinet, Ethernet/IP (Optional)
Interfaces & Openness	SDK (C/C++/C#/Lua/Python/JavaScript Windows + Linux), supporting ROS/ROS2, AP
Power Supply	115/230VAC, 50/60Hz
IP Classification	IP43



I/O Interfaces	Control Cabinet	Tool End
Digital Input	16(Standard),16(Configurable)/8(Safety)	4 (Configurable)
Digital Output	16(Standard),16(Configurable)/8(Safety)	4 (Configurable)
Analog Input	2	2
Analog Output	2	-
RS485 Communication	2	1 (Configurable)
I/O Power	Output Voltage	24V
	Output Current	3A Max
		0V/12V/24V
		2A (3A Max)

Teach Pendant

Product Model	AUBO-TP-IS
Dimensions (L*H*W)	254mm*213.1mm*40.8mm
Weight	1.0kg
IP Classification	IP54
Color	Orange + Black



Disclaimer

1. The content of this product datasheet is subject to change without prior notice.
2. This product datasheet is the intellectual property of our company, and all rights are reserved. Any reproduction or citation of the content must indicate the source. Unauthorized reproduction is strictly prohibited; violators will be considered infringing and will be held legally liable in accordance with the law.



AUBO-i20

i Series Collaborative Robot

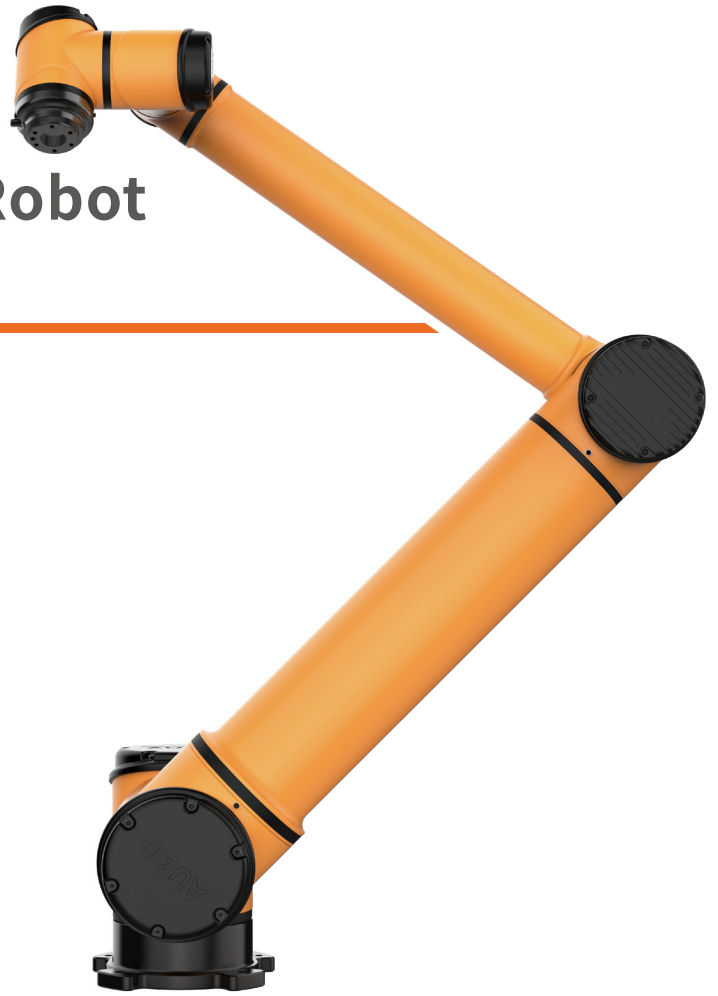

20KG

PAYLOAD



63.7KG

WEIGHT



±0.05mm

REPEATABILITY



1650mm

WORKING RADIUS

- ✓ Payload: 20kg | Joint Rotation: ±360°
- ✓ Max Working Radius: 1650mm | Repeatability: ±0.05mm
- ✓ Highlight: 1:3 payload-to-weight ratio, ideal for various heavy-duty applications.

Applications

3C, Automotive, New Energy, Semiconductors, Machining, Hardware & Appliances, Kitchen/Bath, Healthcare, Research & Education, F&B (Food & Beverage), New Retail, Daily Chemicals, Logistics.



CERTIFICATIONS

- ISO 13849(PL d with Cat. 3)
- CE Certification
- NRTL Certification
- KCs Certification
- CR Certification
- SEMI S2 Certification
- RoHS Certification
- ISO class 4 Cleanroom ISO Class 4



Features & Advantages

(Compared to the previous generation of products)

- 01 Heavy Payload & High Precision:**
20kg payload, 1650mm reach, ±0.05mm repeatability, and a 1:3 payload-to-weight ratio.
- 02 Safe Collaboration:**
Supports force sensors for collision detection and drag-to-teach.
- 03 Intuitive Operation:**
Visual interface; master programming in 30 minutes.
- 04 Open System:**
Supports SDK/API and diverse protocols for seamless integration with grippers, vision, and mobile peripherals.



High Performance



High Precision



Rapid Response



Safe and Stable



Flexible Production



Fine Craftsmanship



Compact and Lightweight



Modular Design



High Protection Class



...

AUBO-i25

i Series Collaborative Robot

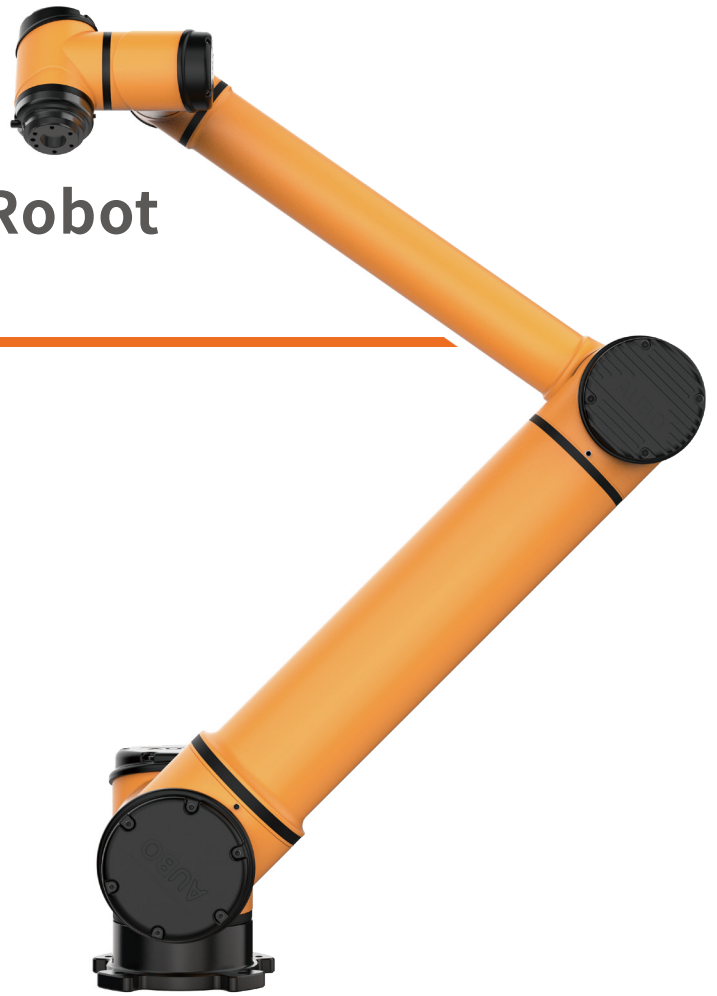

25KG
PAYLOAD



63KG
WEIGHT



±0.1mm
REPEATABILITY



1500mm
WORKING RADIUS

- ✓ Payload: 25kg | Joint Rotation: $\pm 360^\circ$
- ✓ Max Working Radius: 1500mm | Repeatability: ± 0.1 mm
- ✓ Highlight: 1:2.3 payload-to-weight ratio, ideal for various heavy-duty applications.

Applications

3C, Automotive, New Energy, Semiconductors, Machining, Hardware & Appliances, Kitchen/Bath, Healthcare, Research & Education, F&B (Food & Beverage), New Retail, Daily Chemicals, Logistics.



CERTIFICATIONS

- ISO 13849(PL d with Cat. 3)
- CE Certification
- NRTL Certification
- KCs Certification
- CR Certification
- SEMI S2 Certification
- RoHS Certification
- ISO class 4 Cleanroom ISO Class 4



Features & Advantages

(Compared to the previous generation of products)

- 01 Heavy Payload & High Precision:**
20kg payload, 1650mm reach, ± 0.05 mm repeatability, and a 1:3 payload-to-weight ratio.
- 02 Safe Collaboration:**
Supports force sensors for collision detection and drag-to-teach.
- 03 Intuitive Operation:**
Visual interface; master programming in 30 minutes.
- 04 Open System:**
Supports SDK/API and diverse protocols for seamless integration with grippers, vision, and mobile peripherals.



High Performance



High Precision



Rapid Response



Safe and Stable



Flexible Production



Fine Craftsmanship



Compact and Lightweight



Modular Design



High Protection Class



